



F  **BISIA**

ESTABLISHED IN 1988



'The Friendly Games'

Coaches Information

Supported by



Table of contents

<u>Welcome Message</u>	1
<u>A Message From FOBISIA CEO</u>	2
<u>Contacts</u>	3
<u>Aims Objectives Rules Schedules</u>	4
<u>Officials and Marshalling</u>	5
<u>Pattana Sport Resort Venue</u>	6
<u>Other On-Site Facilities</u>	7
<u>Venue Map</u>	8
<u>What to Expect</u>	9
<u>Visiting Parents/Supporters Parent Accommodation</u>	10
<u>Coaches Meetings Child Protection Forms Communication Timelines Participating Schools</u>	11



Welcome Message

Dear coaches and school staff,

On behalf of Sports Management Worldwide and Pattana Sports Resort, we are proud to welcome all schools, teachers, parents and most importantly your students and competitors to Pattana Sports Resort, the new 'Home' of the FOBISIA Friendly Games.

Our aim is to provide a positive, inspiring and memorable experience for all involved. At the heart of our organisation is the motivation to create an environment that offers an opportunity for our competitors to realise their potential, foster personal growth and engage with other athletes, forming lasting friendships in the context of 'The Friendly Games'.



Here you will find information on Pattana Sports Resort's accommodation, dining, facilities, services and activities .

Welcome to Thailand, Pattana Sports Resort and the FOBISIA 'The Friendly Games'.



A message from FOBISIA CEO

We would like to extend a warm welcome to coaches and teachers to the FOBISIA Friendly Games, on the 30th anniversary of the very first Games.

Our aim is to provide a positive, inspiring and memorable experience for all involved.

At the heart of our organisation is the motivation to create an environment that offers an opportunity for our competitors to realise their potential, foster personal growth and engage with other athletes, forming lasting friendships in the context of 'The Friendly Games'.

We are immensely grateful to you, the PE Teachers and Coaches who work so hard to train and encourage your students, liaise with parents and coordinate the logistics of the trip.

Without your support this event could not take place.

We are thrilled to return after a 3 year absence, and I wish you all a great FOBISIA Friendly Games!

John Gwyn Jones MBE
CEO FOBISIA



Contacts

Jason Robertson - SMW Event Manager

(contact for all FOBISIA Friendly Games onsite enquiries)

Email: jason@sm-worldwide.com

Jason comes from a professional sports and events background and has been involved with the FOBISIA Friendly Games since 2018. Recently taking over this new role as Event Manager.

Jason has a clear understanding of the expectations of the Friendly Games and how to deliver them to the highest standard.

Janine Minchin - Student Events Executive

(FOBISIA HQ)

Email: student-events@fobisia.org

FOBISIA HQ oversees the running of the FOBISIA Friendly Games. Feedback relating to the Friendly Games will be requested from FOBISIA HQ to help with future planning.

Andrea Krapf - SMW General Manager

(oversees communication of accommodation/payment operations)

Email: andrea@sm-worldwide.com

PARENT LIAISONS:

Prior and During the games:

Chayanat (Benz)SriChompoo - Pattana Sports Resort

Email: chayanat.s@pattana.co.th



Aims

To provide students with a variety of sporting opportunities at an appropriate level for all member schools in a safe and competitive environment.

Objectives

- To make sporting competition (via the Games) accessible to children from Year 5 upwards.
- To ensure equal opportunity and participation for both boys and girls.
- To ensure the Games provide a learning experience in sportsmanship and in the value of healthy competition.
- To understand the value and the benefits of training in preparation for competition.
- To enable students to specialise in sports appropriate to their age groups.

Rules

All rules are available in the FOBISIA Friendly Games Handbooks which can be found on the FOBISIA Website.

- Please see [here](#) for the FOBISIA Secondary Friendly Games Handbook (Covers both U13 and U15).

Game Schedules

These will be made available to schools prior to the games.



Results

These will be made available to all schools after the event as well as our website www.scafobisiagames.com

Officials and Marshalling

The success of the Games requires a considerable number of trained and experienced officials.

Local officials and onsite staff will be provided with the required training.



Pattana Sport Resort

<https://pattana.co.th/>

Venue



Top: The 50m pool with starting blocks and touch pads



FOOTBALL STADIUM

- 7,000-seat capacity
- Three football practice fields
- Built to FIFA Specifications





Top: 400m grass running track with rubberised area for high jump and long/triple jump with stadium seating.

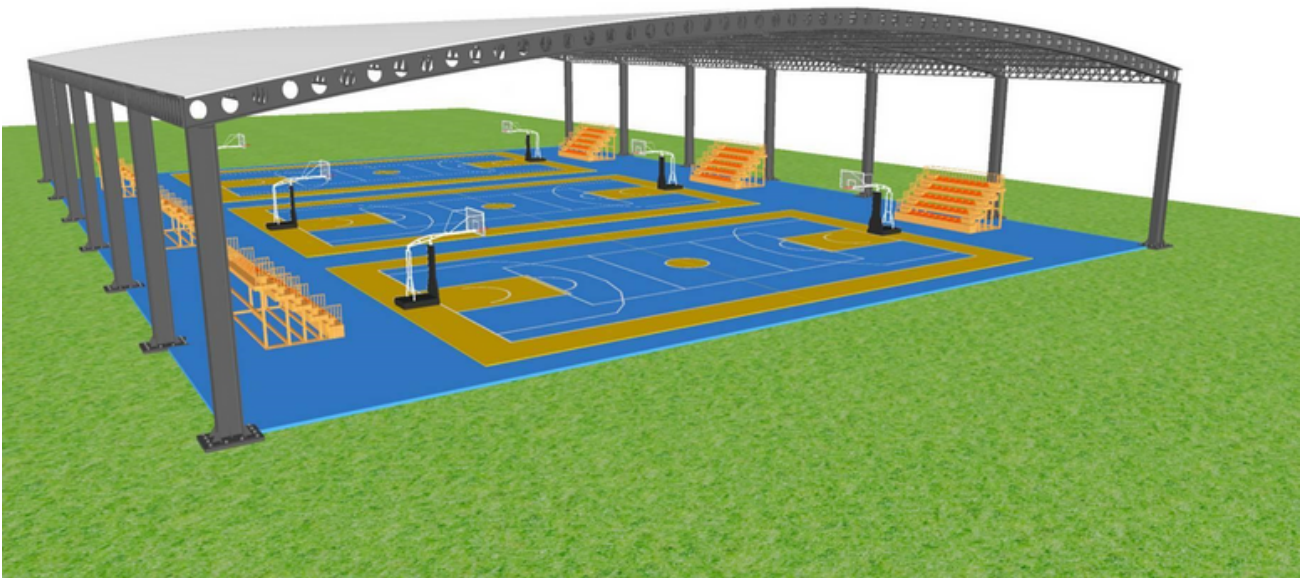

Three newly built, covered Basketball Courts with grandstand seating.



Other On-Site Facilities



PATTANA GOLF

We offer three courses of varying abilities with 27 holes total, creating a challenging layout and ideal training ground for both experienced and leisure golfers. Undulating fairways, panoramic views, varying wind conditions, fast greens and a signature par-six hole are just some of the obstacles waiting to be tackled.

A mountainous backdrop, elevated greens, deep bunkering and grass mounts result in a visually appealing yet challenging course for players of all levels. Water is abundant at Pattana where both tee and approach shots require careful placement. A 30-lane driving range and putting green let you practice your shots before taking the main course.



IT'S ALWAYS GAME DAY AT PATTANA.

With 27 challenging holes, Pattana is the ideal training ground for both experienced and leisure golfers. Undulating fairways, panoramic views, varying wind conditions, fast greens and a signature par-six hole are just some of the obstacles waiting to be tackled



BIKE LANE

- 6km



"Restore balance and emerge refreshed and energized."



You're never too young for some Pattana fun! Kids have a special space to learn and play at iWise Kids' Club, located in



PATTANA SPA

Looking for a way to wind down after a round of golf? Need relief for sore muscles? Slip into Pattana Spa and let our professional massage therapists soothe your muscles and ease your soul.

Restore balance with our selection of rejuvenating spa treatments. Emerge refreshed and energized, ready for the next challenge. The Pattana Spa is easily accessible from the hotel, golf course or any of our sports facilities.



RUNNING TRACK

- 1km



ENERGY LAB

Operation hours: 08:00 - 21:00hrs



Venue Map



PATTANA MAP



INFORMATION

- Course A** (A) Club House (1) O-Ren Sun (19) Swimming Pool (13) Driving Range (7) Car Park (P)
- Course B** (B) EnergyLab (2) Strings & Jugs (20) Football Pitches (14) Stadium (8) Obstacle (9) Mansion (10) Hotel (4) Golf Cart (5) Canteen (6) Toilet (T)
- Course C** (C) Conventionhall (3) A-Slice (21) The Arena Basecamp Cafe' (15) FAME (16) Field 1 (11) Field 2 (12) Field 3 (24) Gate 1 (G1) Gate 2,3 (G2,3) Shuttle Bus (S)
- Maintenance (23) Villa (22) The Barn (17) Khun.P (18)



What to Expect

Sports Facilities

400m, 8 lane grass Athletics Track for the 1st year and Synthetic Track for the 2023/2024 Games, onwards.

50m, 10 lane swimming pool with grandstand and touchpad facilities

4 full-size football pitch

3 covered basketball courts

6 km bike lane

1 km running track

Other Sporting Facilities

Fully Equipped Gym (Energy Lab)

Fitness Studios for Yoga, Pilates, Dance, Spin Class and Muay Thai

Muay Thai Boxing Ring

27 Hole Championship Golf Course

Golf Driving Range

Spa Facilities

Spa's Wellbeing Center offers a range of therapies and treatments.

Dining & Refreshments

Schools are required to complete the relevant medical and dietary forms prior to their arrival. These will inform the kitchen and ensure we can provide suitable meals, including Halal, and other special requirements for all our guests.

Breakfast and evening meals will be held in the hotel restaurant.

Packed lunches will be provided and served at Basecamp each day.

An afternoon snack will be provided each day.

Students and staff will be provided with a drinking bottle upon arrival from SMW which will be needed throughout the games at water stations.

Several water stations will be provided at each venue. Water dispensers will also be available in the accommodation wings. Isotonic drinks will be provided but limited. Schools should bring additional rehydration salts.

Medical

During The Games Events we will offer on site medical care with ambulance facilities.

The Hotel also offers on-site medical care for guests.

After Hours: An onsite medical assistance is available 24 hours.



Closest Hospitals



Piyawetch Hospital Bo Win:

28/8 Moo 8, Ban Sriracha, Chon Buri, Thailand 20230.

+6638 345 111, +6638 345 333

8 Km. away from Pattana Sports Resort (10 minutes)



Samitivej Sriracha Hospital:

8 Soi Laemket, Jermjompol Rd., Sriracha, Chonburi 20110

+6638 320 300

30 Km. away from Pattana Sports Resort (30 minutes)

You will be asked to pay for any treatment required and then complete the necessary documentation to provide to your insurance company to make a claim



Opening Ceremony

There will be a brief opening ceremony prior to the first event of the games. This will take the form of a parade and brief introduction and welcome.

Gala Dinner

The Gala Dinner will take place on the evening of the last day of the competition. The dinner will be provided for all members of the official school party.

The venue for the gala dinner will be dependent upon the size of the group. Schools will be notified at the games of the gala dinner venue. The format of the evening will include formal presentations of awards and a celebration video reflecting their FOBISIA experience. Speeches and presentations will be kept to a minimum.

The swimming and athletics trophies will be awarded and schools should prepare two student representatives to receive awards.

Any outstanding awards will also be presented. The provision of entertainment will be appropriate to the age of the students, aimed at encouraging interaction.



Arrival & Transportation

Schools are required to submit their flight details and participation numbers in advance of arrival (see Admin Forms and deadlines). "

Schools are responsible for checking passports (6 months validity) and necessary visa applications. Should schools require letters to support visa applications, please contact the tournament director for support.

A copy of each member of the group's passport should be sent to the Tournament Director before arrival to aid in a smoother check-in process on arrival and so they always keep their passports in their possession.

A member of Pattana Sports Resort staff will meet you at the airport and assist you with getting on the bus to The Resort.

(the bus ride should take 75min).

All buses will have access to seatbelts.

Luggage will travel in a separate truck for small vans and in the stowage compartment on a 30-40 seater bus.

Upon arrival, you will be given an orientation of the facilities. Your luggage will be sent directly to the hotel accommodation, unloaded and be waiting for collection when you arrive at the hotel reception.

The lead teacher will need to complete registration documents and your keys will be ready.

One key card will be allocated for each room and the lead teacher will receive a key card for all the school's assigned rooms. Please note schools will be charged by the hotel for the loss of key cards.

Security & Safety

The hotel is a gated complex with 24-hour security personnel at each gate entrance.

During the games, additional security is placed at the accommodation from 7.00 pm to 7.00 am.

The external windows and doors of the hotel rooms are locked to ensure the safety and security of the students.

In order to identify authorized coaching staff on-site, accompanying staff are requested to wear FOBISIA lanyards at all times.

In the event of a fire or evacuation in the main building, all guests must assemble at the main lobby entrance, wing-A entrance and wing-B entrance.

If an evacuation is required from the hotel accommodation, the assembly point is at the hotel carpark. Assembly points are signposted and will be shown to staff during facilities orientation.



Lightning policy

Pattana Sports Resort's lightning system is based at the pool. If triggered, lifeguards will alert all those on site to clear the pool or field and seek refuge away from open areas and go inside. A period of (30) thirty minutes must elapse (thirty-minute rule) before resuming activities. If there is any subsequent lightning or thunder after the beginning of the 30-minute count time then another count will begin.

Student Accommodation

Pattana hosts two accommodation wings that schools will be accommodated in:

Mansion has 70 rooms, which offer views of the surrounding gardens.

Main Hote has 170 rooms with views over the golf course and resort swimming pool.

Note: Our priority is the well-being and safety of visiting schools. As such, parent supporters should stay in alternative accommodation in order to allow staff to monitor their own teams satisfactorily and not put a strain on hotel resources.

Accommodation is based upon triple share. Schools are required to complete the rooming list form prior to arrival.

Boys and girls will be roomed separately and schools are provided with rooms, which enable staff to maintain close supervision of their party as far as possible.

Rooms are safe, i.e. windows are locked, no access to balconies etc. Mini-bars are emptied and International Direct Dialling services are disconnected.

During out-of-hours, on-site medical assistance is available. Contact hotel reception or dial 0 for the operator who will call medical staff/ambulance in case of emergency.

Should you need anything during your stay please contact the hotel reception and the staff will be happy to assist you.

For other issues, you should contact the Tournament Director.



Visiting parents/Supporters

Information for parents and supporters can be found in the parent handbook. Or for further information when at the games please contact Benz at Pattana Resort, at the parent liaison desk, to be found in the main Clubhouse.





The Games Schedules will be forwarded to schools prior to the games and schools are welcome to distribute this information to parents. Copies of the programme will also be displayed at the venues for parents to view.

Parent Accommodation

Participating schools are asked to reinforce to their parents that they are not allowed to stay at Pattana Resort for the duration of the games.

FOBISIA, SMW and Pattana Sports Resort work hard to ensure the safety and protection of all students and hope you will understand and cooperate with us on this matter and trust our safeguarding policies.

Below are detailed recommendations we have worked hard to find for parents to stay close by and have a comfortable experience in Eastpana Hotel, Sriracha.

-  287/162 Moo 3 Bowin, Sriracha, Chonburi 20230
-  033-047-070
-  www.eastpana.com
-  [eastpanahotel.bowin](https://www.facebook.com/eastpanahotel.bowin)
-  (10 minute drive to Pattana Sport resort)



Enjoy your family getaway at Eastpana Hotel in affordable price with the best available rate for our FOBISIA Games Parents!
Please mention "["FOBISIA 2022"](#) during reservation



Coaches Meetings

There will be nightly coaches' meetings to provide information for the following day's events.

Beginning with a welcome meeting on the evening prior to the first event of the games.

Child Protection Forms

All schools will need to complete the Child Protection Forms prior to arrival. These will be distributed by Sports Management Worldwide.

Please return a scanned copy of the documents to:

Jason Robertson, SMW Event Director.

Communication/Timelines

All information regarding the games will be communicated to the schools.

Participating Schools

It is essential that all participating schools supply information efficiently and meet all deadlines on requests from the organisers.

These deadlines, along with projected costs and facilities, will be outlined through communication with trip leaders and can be found on the games website.

